



JAMIE WARNER
— ESTATE AGENTS —



4 Hills Cottages, Cemetery Road, Wickhambrook, Newmarket, CB8

Guide Price £300,000

- Three Bedrooms
- Bathroom & Separate WC
- Double Glazing & Oil Central Heating
- Two Reception Rooms
- Generous Plot
- No Onward Chain
- Fitted Kitchen
- Garage & Off-Road Parking

2 Rosefinch Close, Haverhill, Suffolk, CB9 0JS
01440 712221

jamie@jamie-warner.co.uk
www.jamie-warner.co.uk

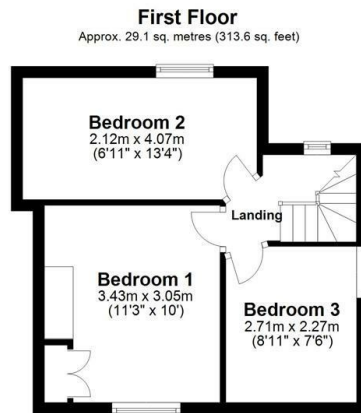
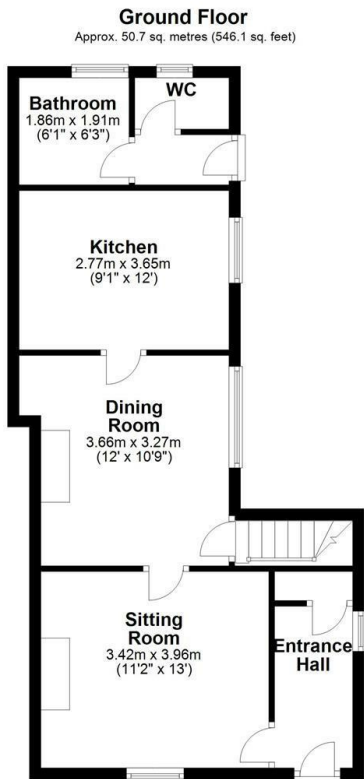

Total area: approx. 79.9 sq. metres (859.6 sq. feet)

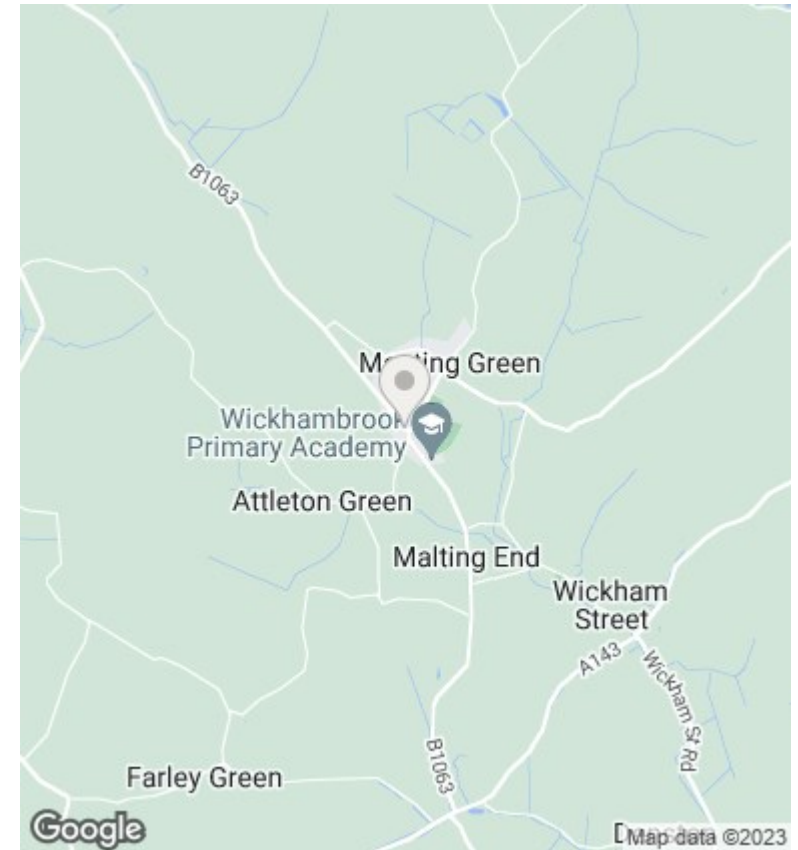

Directions

Viewings

Viewings by arrangement only. Call 01440 712221 to make an appointment.

Council Tax Band

EPC Rating:

Energy Efficiency Rating		Current	Potential
<i>Very energy efficient - lower running costs</i>			
(92 plus)	A		
(81-91)	B		
(69-80)	C		
(55-68)	D		
(39-54)	E		
(21-38)	F		
(1-20)	G		
<i>Not energy efficient - higher running costs</i>			
England & Wales		EU Directive 2002/91/EC	